



## GENERIC SPECIFICATION

# Enviroflex® 20

### GUIDE SPECIFICATION FOR THE APPLICATION OF ENVIROFLEX® DIRECT TO PLYWOOD OR OSB

#### PREPARATION

- A. Protect adjacent surfaces not designated to receive waterproofing.
- B. Do not apply waterproofing to surfaces unacceptable to manufacturer.
- C. All fixed items such as cables, wires, pipes etc. should be removed or suspended away from the surface. The ENVIROFLEX® waterproofing must cure for a minimum of 24 hours before replacing or reinstating. Care should be taken not to damage the waterproof covering when replacing such items.
- D. Clean and prepare surfaces to receive waterproofing by removing all loose and flaking particles, grease, dirt and laitance. Special attention should be given to areas covered with fungal or algae growth, these surfaces must be treated with a suitable fungicidal wash.
- E. Exposed metal surfaces to be coated must be clean, oil and grease free and free of loosely adhering particles. Remove loose rust and mill scale by wire brush, abrasive disk or sand paper. Rusted areas should then be coated with Sealoflex® Rust X-2020 prior to application of Sealoflex® Metal Etch Primer.
- F. Inspect the substrate for defects and make repairs as necessary in accordance with manufacturer's instructions.
- G. Ensure any timber works are fully secure and fixed as per the manufacturer's specification.
- H. All existing flashings that are to remain must be inspected and repaired or replaced. Flashings are to be lifted and the system installed up to the underside of the flashing. The ENVIROFLEX® waterproof coating must be allowed to cure for a minimum of 24 hours before returning flashings into position.
- I. All cappings and copings must be inspected before commencing the waterproofing application and re-fixed or replaced where required. Removal of cappings and copings should be considered where appropriate.
- J. Prior to application of the field area membrane, apply a light coat of ENVIROFLEX® Liquid Waterproof Coating directly over the substrate board joints and embed the 100mm wide reinforcement fabric with a dry roller.

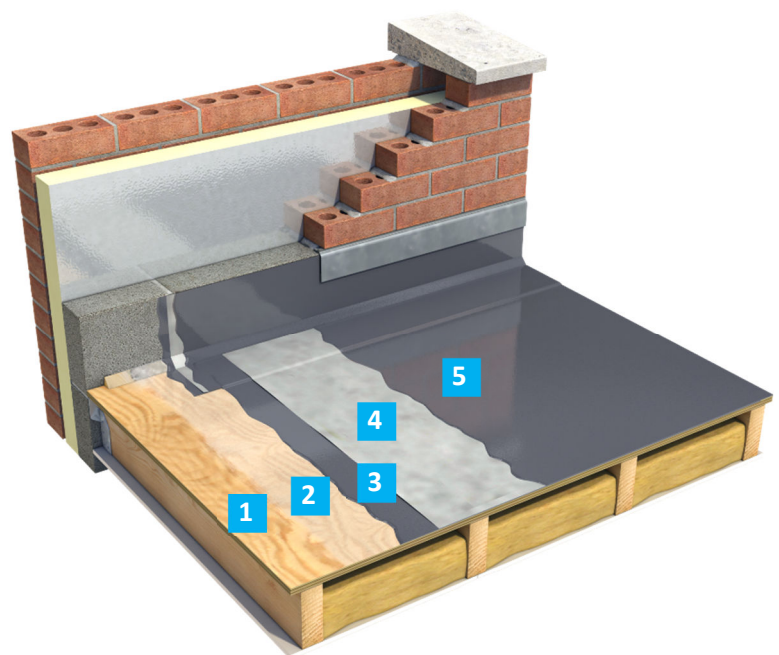

- 1 Plywood or OSB
- 2 ENVIROFLEX® EP1 Primer
- 3 ENVIROFLEX® Waterproof Coating (base)
- 4 ENVIROFLEX® Reinforcing Fabric
- 5 ENVIROFLEX® Waterproof Coating (top)

# Enviroflex® 20

Direct to Plywood or OSB

## ENVIROFLEX® LIQUID MEMBRANE

### Priming

Note: Prior to commencing the application of the ENVIROFLEX® waterproofing system, an adhesion test should be carried out to ensure the system is bonding to the substrate. All coverage rates provided are the MINIMUM requirements and individual project substrates will vary.

Apply **ENVIROFLEX® EP1 PRIMER** to all timber surfaces using a brush or roller and allow to cure. Once applied the surface of the timber must have a mid-sheen finish. In some instances, it may be deemed necessary to prime the surface more than once to achieve the finish required. ENVIROFLEX® EP-1 Primer coverage is a MINIMUM of 0.1 ltr/m<sup>2</sup>.

Curing: Curing time is typically 30 minutes to 1 hour. Allow the primer to cure thoroughly before over coating. Maximum over coating time is 8 days. If left longer, the substrate should be re-primed. Primer MUST fully coat the substrate and have a continuous even colour throughout, if this is not visible apply further coat or coats until it is achieved. Note: Primer appears white following initial application, however cures to leave a transparent finish. Other construction substrates should be primed with the appropriate primer where required. Consult product information sheets for guidance.

### Field Area Membrane

Once the surface is fully prepared and ready to accept the ENVIROFLEX® Membrane, apply a covering of the **ENVIROFLEX® WATERPROOF COATING**, using a squeegee and roller at a minimum coverage rate of 0.6 ltr/m<sup>2</sup>. This must be done in small sections no greater than 1 m<sup>2</sup>. Immediately embed the **ENVIROFLEX® REINFORCEMENT FABRIC** into the wet embedment coat, with a brush or dry roller, smooth the reinforcement fabric and ensure that it is fully saturated. Immediately apply a second coat of the **ENVIROFLEX® WATERPROOF COATING** directly over the saturated reinforcement fabric ensuring that there are no visible signs of the reinforcement guide lines at a minimum coverage rate of 0.9 ltr/m<sup>2</sup>. All reinforcement fabric overlaps must be a minimum of 75mm making sure that sufficient coating is used to saturate the overlap.

Alternatively, apply the top coat at the standard system rate of 0.6 ltr/m<sup>2</sup> and allow to cure before applying an layer of the ENVIROFLEX® Waterproof Coating at 0.3 ltr/m<sup>2</sup>. This may provide a more even distribution of the coating and an improved surface finish.

Total Membrane Coverage Rate: ENVIROFLEX® Liquid Waterproof Coating: 1.5 ltr/m<sup>2</sup>

### Perimeter Edge Detail & Upstands

Apply the ENVIROFLEX® waterproofing system to the detail, in accordance with the main specification. Apply the base layer of coating to the detail at the specified coverage rate, ensuring a minimum 100mm overlap to adjacent field areas. Unroll the ENVIROFLEX®™ Reinforcement Fabric into the coating ensuring the fabric is pressed tightly into the angle. Press the fabric into position vertically and horizontally, ensuring creases or wrinkles are removed. Immediately apply the top layer of waterproof coating above the saturated reinforcement fabric at the specified coverage rate.

At all upstands the waterproofing system should be installed so that continuity is maintained for a vertical height of not less than 150 mm above finished roof level, in accordance with BS 6229.

### Protective Walkway covering

Once the ENVIROFLEX® Liquid Waterproof Coating has been allowed to cure, apply one further light coat of the **ENVIROFLEX® WATERPROOF COATING** using a roller or squeegee to a maximum thickness of 0.3 ltr/m<sup>2</sup>.

Working in sections no greater than 1 m<sup>2</sup>, immediately broadcast the **ENVIROFLEX® QUARTZ** granules into the wet coating at a rate of 2.5 kg/m<sup>2</sup>. Allow the system to cure for approximately 2-3 hours before sweeping away the excess coloured quartz crystals.

Apply a minimum of two coats of **ENVIROFLEX® WEAR COAT** over the walkway areas at a finished rate of 0.25 ltr/m<sup>2</sup> per coat. Walk on time for the ENVIROFLEX® Anti-Skid Surfacing is approximately 24 hours depending on coverage rate used and ambient conditions.

Allow to fully cure before trafficking.

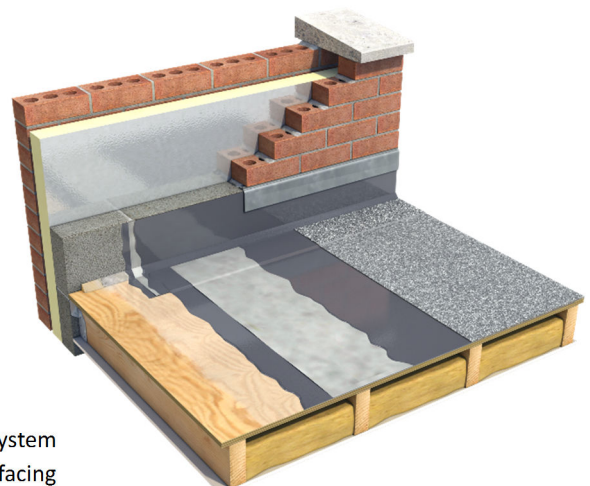

ENVIROFLEX® Waterproofing System  
incorporating the Enviroflex Anti-Skid Surfacing